

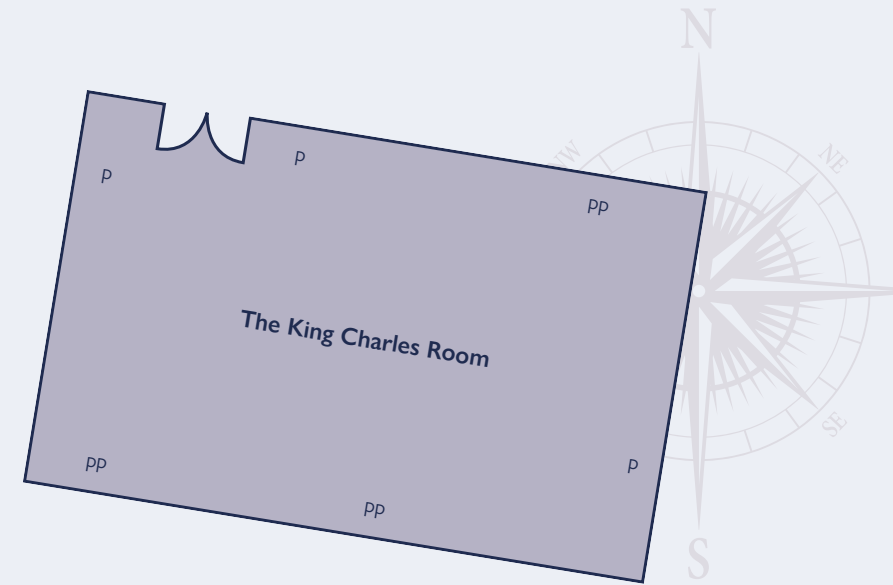

## The King Charles Room

This lovely room, named after King Charles II whose original portrait by Mary Beale is on the wall, features a nice terrace with direct access to the 35 acres of the Beale Arboretum surrounding the hotel.

The room has a high ceiling, air conditioning and three large sash windows as well as beautiful views and easy access to the front entrance. This richly decorated room is ideal for a smaller group of family and friends, gathered to witness your wedding ceremony.



### Capacities

Ceremony	35
Round Tables	27
Combination Layout	26
Top Table & Sprigs	26
Oval	20
Informal	30

<b>KEY</b>	<b>P</b> power sockets
------------	---------------------------

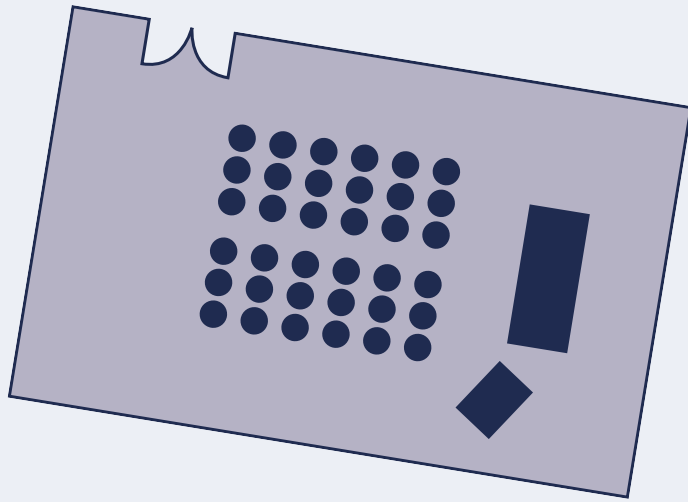

Ceremony

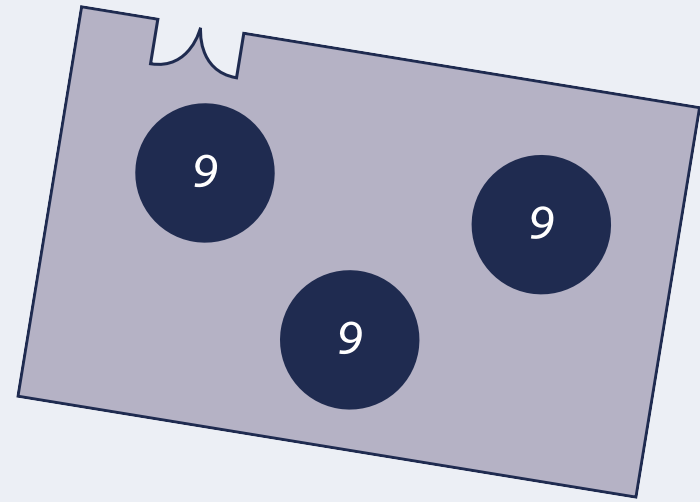

Rounds

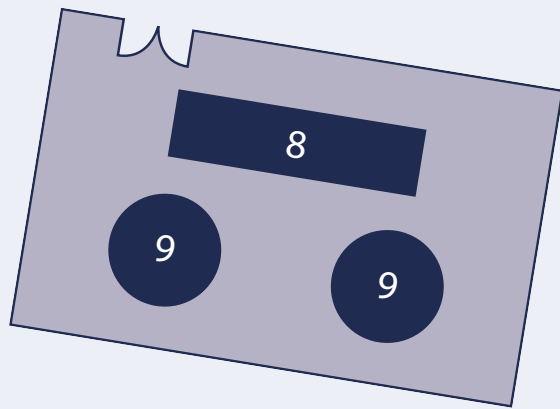

Combination

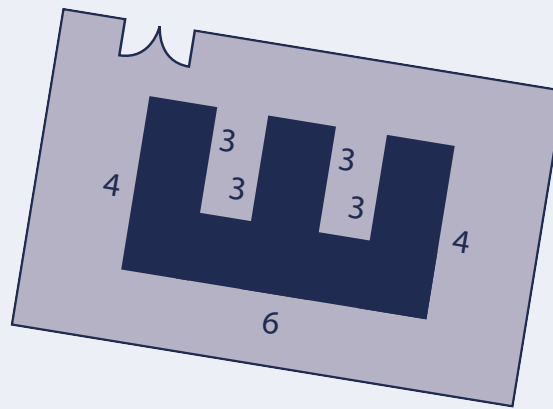

Top Table & Sprigs

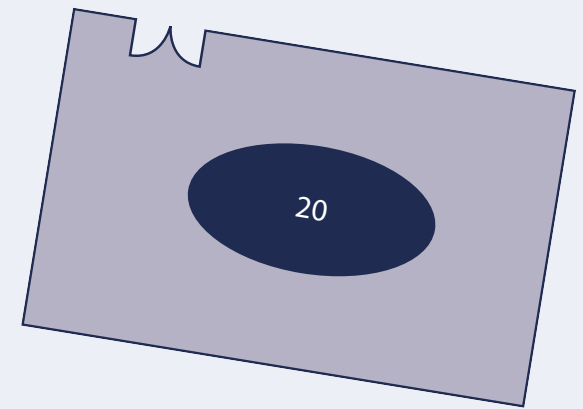

Oval